

Instruction manual

Cordless Orbital Sander

CCOS20V2A (DY94429)



Original instructions

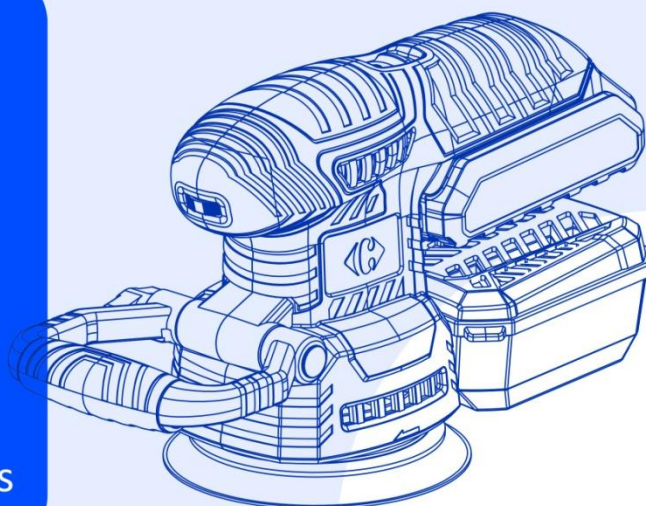



Congratulation on your purchase.

The quality team at CARREFOUR cares for its products to meet conformity and performances. Paying close attention to your satisfaction, our experts work all day on the improvement of our products.



For assembly and/or maintenance and/or use of your product, you can use:

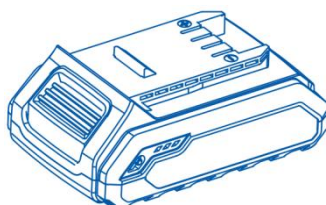

These products are available in CARREFOUR stores.



Read this manual carefully

For a better use of your new device, we recommend you to read carefully this Instruction Manual and keep it for record.

Keep it carefully for future reference.











Please also find information about the scraping of the product in this Instruction Manual.



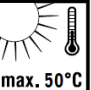

Safety instructions

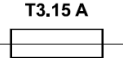
Before installing or using the product, please read carefully the safety measures after the summary.

Pictograms used

	Warning symbols with information on damage and injury prevention
	Read the operation instructions carefully.
	Read and understand all instructions before operating the product. Follow all warnings and safety instructions
 Li-ion	Electrical products must not be disposed of with the domestic waste.
	Protect the rechargeable battery from sunlight and heat (max.50°C)
	Protect the rechargeable battery from water and moisture
	Protect the rechargeable battery from fire
	The charger is for indoor use only
	Miniature fuse
	Protection class II (double insulation)

WARNING! Wearing the personal equipment

	Wear hearing protection.
	Wear safety glasses.

CONTENTS

SAFETY INSTRUCTIONS	5
PRODUCT DESCRIPTION.....	10
INTENDED USE.....	13
BEFORE USE.....	13
OPERATION	15
CLEANING & MAINTENANCE	16
STORAGE AND TRANSPORTATION	16
REPLACEMENT PARTS /ACCESSORIES	16
TROUBLESHOOTING	17
DISPOSAL	17
DECLARATION OF CONFORMITY	18
WARRANTY	19
PRODUCT FAILURE.....	20
WARRANTY EXCLUSIONS.....	21

SAFETY INSTRUCTIONS

GENERAL POWER TOOL SAFETY WARNINGS

WARNING Read all safety warnings, instructions, illustrations and specifications provided with this power tool. Failure to follow all instructions listed below may result in electric shock, fire and/or serious injury.

Save all warnings and instructions for future reference.

The term "power tool" in the warnings refers to your mains-operated (corded) power tool or battery-operated(cordless) power tool.

1. Work area safety

- a) **Keep work area clean and well lit.** Cluttered or dark areas invite accidents.
- b) **Do not operate power tools in explosive atmospheres, such as in the presence of flammable liquids, gases or dust.** Power tools create sparks which may ignite the dust or fumes.
- c) **Keep children and bystanders away while operating a power tool.** Distractions can cause you to lose control.

2. Electrical safety

- a) **Power tool plugs must match the outlet. Never modify the plug in any way. Do not use any adapter plugs with earthed (grounded) power tools.** Unmodified plugs and matching outlets will reduce risk of electric shock.
- b) **Avoid body contact with earthed or grounded surfaces, such as pipes, radiators, ranges and refrigerators.** There is an increased risk of electric shock if your body is earthed or grounded.
- c) **Do not expose power tools to rain or wet conditions.** Water entering a power tool will increase the risk of electric shock.
- d) **Do not abuse the cord. Never use the cord for carrying, pulling or unplugging the power tool. Keep cord away from heat, oil, sharp edges or moving parts.** Damaged or entangled cords increase the risk of electric shock.
- e) **When operating a power tool outdoors, use an extension cord suitable for outdoor use.** Use of a cord suitable for outdoor use reduces the risk of electric shock.
- f) **If operating a power tool in a damp location is unavoidable, use a residual current device (RCD) protected supply.** Use of an RCD reduces the risk of electric shock.

3. Personal safety

- a) **Stay alert, watch what you are doing and use common sense when operating a power tool. Do not use a power tool while you are tired or under the influence of drugs, alcohol or medication.** A moment of inattention while operating power tools may result in serious personal injury.
- b) **Use personal protective equipment. Always wear eye protection.** Protective equipment such as a dust mask, non-skid safety shoes, hard hat or hearing protection used for appropriate conditions will reduce personal injuries.
- c) **Prevent unintentional starting. Ensure the switch is in the off-position before connecting to power source and/or battery pack, picking up or carrying the tool.** Carrying power tools with your finger on the switch or energising power tools that have the switch on invites accidents.
- d) **Remove any adjusting key or wrench before turning the power tool on.** A wrench or a key left attached to a rotating part of the power tool may result in personal injury.
- e) **Do not overreach. Keep proper footing and balance at all times.** This enables better control of the

power tool in unexpected situations.

f) Dress properly. Do not wear loose clothing or jewellery. Keep your hair and clothing away from moving parts. *Loose clothes, jewellery or long hair can be caught in moving parts.*

g) If devices are provided for the connection of dust extraction and collection facilities, ensure these are connected and properly used. *Use of dust collection can reduce dust-related hazards.*

h) Do not let familiarity gained from frequent use of tools allow you to become complacent and ignore tool safety principles. *A careless action can cause severe injury within a fraction of a second.*

4. Power tool use and care

a) Do not force the power tool. Use the correct power tool for your application. *The correct power tool will do the job better and safer at the rate for which it was designed.*

b) Do not use the power tool if the switch does not turn it on and off. *Any power tool that cannot be controlled with the switch is dangerous and must be repaired.*

c) Disconnect the plug from the power source and/or remove the battery pack, if detachable, from the power tool before making any adjustments, changing accessories, or storing power tools. *Such preventive safety measures reduce the risk of starting the power tool accidentally.*

d) Store idle power tools out of the reach of children and do not allow persons unfamiliar with the power tool or these instructions to operate the power tool. *Power tools are dangerous in the hands of untrained users.*

e) Maintain power tools and accessories. Check for misalignment or binding of moving parts, breakage of parts and any other condition that may affect the power tool's operation. If damaged, have the power tool repaired before use. *Many accidents are caused by poorly maintained power tools.*

f) Keep cutting tools sharp and clean. *Properly maintained cutting tools with sharp cutting edges are less likely to bind and are easier to control.*

g) Use the power tool, accessories and tool bits etc. in accordance with these instructions, taking into account the working conditions and the work to be performed. *Use of the power tool for operations different from those intended could result in a hazardous situation.*

h) Keep handles and grasping surfaces dry, clean and free from oil and grease. *Slippery handles and grasping surfaces do not allow for safe handling and control of the tool in unexpected situations.*

5. Battery tool use and care

a) Recharge only with the charger specified by the manufacturer. *A charger that is suitable for one type of battery pack may create a risk of fire when used with another battery pack.*

b) Use power tools only with specifically designated battery packs. *Use of any other battery packs may create a risk of injury and fire.*

c) When battery pack is not in use, keep it away from other metal objects, like paper clips, coins, keys, nails, screws or other small metal objects, that can make a connection from one terminal to another. *Shorting the battery terminals together may cause burns or a fire.*

d) Under abusive conditions, liquid may be ejected from the battery; avoid contact. If contact accidentally occurs, flush with water. If liquid contacts eyes, additionally seek medical help. *Liquid ejected from the battery may cause irritation or burns.*

e) Do not use a battery pack or tool that is damaged or modified. *Damaged or modified batteries may exhibit unpredictable behaviour resulting in fire, explosion or risk of injury.*

f) Do not expose a battery pack or tool to fire or excessive temperature. *Exposure to fire or temperature above 130 °C may cause explosion.*

g) Follow all charging instructions and do not charge the battery pack or tool outside the

temperature range specified in the instructions. Charging improperly or at temperatures outside the specified range may damage the battery and increase the risk of fire.

6. Service

a) **Have your power tool serviced by a qualified repair person using only identical replacement parts.**

This will ensure that the safety of the power tool is maintained.

b) **Never service damaged battery packs.** Service of battery packs should only be performed by the manufacturer or authorized service providers.

SPECIFIC SAFETY INSTRUCTIONS FOR SANDER

1. **Secure the workpiece.** A workpiece securely held by a clamping device or vice is much safer than one held in one hand.
2. **Do not rest your hands next to or in front of the appliance and the area being worked as there is a risk of injury if you slip.**
3. **RISK OF FIRE DUE TO FLYING SPARK !** Sanding metal causes sparks to be produced. Therefore, make sure that nobody is at risk and that no combustible materials are located in the immediate vicinity of where you are working.
4. **WARNING! TOXIC VAPOURS!** Working with the tool can produce harmful/toxic dusts that represent a health hazard for the person operating the appliance and for any other people in the area.
5. **WARNING! RISK DUE TO DUST!** When working for extended periods of time on wood and in particular, materials that produce dust that is hazardous to health, connect the appliance to a suitable external dust extraction appliance. **Wear Safety goggles and a protective dust mask!**
6. **Provide sufficient ventilation when working on plastics, paints, lacquers, etc.**
7. **Do not soak the materials or the area to be processed with liquids containing solvents.**
8. **Never work on moistened materials or damp surfaces.**
9. **Hold the two handles of the appliance when operating.**
10. **Avoid sanding lead paint or other harmful materials.**
11. **Materials containing asbestos must not be processed. Asbestos is a known carcinogen.**
12. **Avoid contact with the sanding sheet while the appliance is running**
13. **Do not use the appliance without a sanding sheet fitted.**
14. **Never use the appliance for other purposes and only use original parts/accessories. Using attachments or accessory tools other than those recommended in the operating instructions can lead to a risk of injury.**
15. **Always allow the appliance to come to a complete standstill before putting it down.**
16. **The appliance must always be kept clean, dry and free from oil or grease.**

SPECIAL SAFETY INSTRUCTIONS FOR BATTERY-OPERATED TOOLS

- a) **Ensure that the tool is switched off before inserting the battery.** Inserting a battery into a tool that is switched on may result in accidents.
- b) **Recharge the batteries indoors only because the battery charger is designed for indoor use only.** Risk of electric shock.
- c) **To reduce the electric shock hazard, unplug the battery charger from the mains before cleaning the charger.**

- d) **Do not subject the battery to strong sunlight over long periods and do not leave it on a heater.** Heat damages the battery and this is risk of explosion.
- e) **Allow a hot battery to cool before charging.**
- f) **Do not open up the battery and avoid mechanical damage to the battery. Risk of short circuit and fumes may be emitted that irritate the respiratory tract.** Ensure fresh air and seek medical assistance in the event of discomfort.
- g) **Do not use non-rechargeable battery.** This could damage the appliance.
- h) **The recommended ambient temperature range for the charging system during charging is from 4°C to 40 °C.**
- i) **The recommended ambient temperature range for tool and battery storage is from 0°C to 50 °C.**
- j) **The recommended ambient temperature range for tool and battery use is from -5°C to 50 °C.**
- k) **Remove the battery from the device before storage.**
- l) **Electrolyte leaking from the cells can cause damage to the skin, clothes or any other items exposed to it. If the electrolyte contacts the skin or clothes, wash thoroughly with clean water. If the electrolyte enters into the eyes, do not rub the eyes but flush them immediately with copious amounts of clean water such as tap water, and immediately consult a doctor.**
- m) **Do not disassemble or modify the battery, which can cause short-circuiting between cells or between the cell and its wiring, and disables the battery's safety protection system. These can lead to electrolyte leakage, overheating or a cell or battery, bursting and fire.**
- n) **Avoid casual or inadvertent shorting of a battery with metallic objects such as: wire, tools, neckless or hairpins, which can cause short-circuiting, which cause excess current flow, electrolyte leakage, heating of cells or batteries, bursting and fire.**
- o) **Keep battery away from a fire or heat. The insulation materials will melt and the gas release vent and protection system will be damaged, causing electrolyte leakage, bursting and possibly fire.**
- p) **Not allow the battery to contact with water or gets wet, it may short-circuit, overheat, rust or lose its functions.**
- q) **Do not expose the battery to mechanical shock, for example, by dropping, throwing or crushing, causing electrolyte leakage, cell and battery heating, bursting and fire.**
- r) **Avoid the battery to directly connect to electric source such as a car lighter socket, or car battery, which may cause excess current to flow at high voltage and can cause electrolyte leakage, overheating of a cell or battery, bursting and fire.**

SAFETY INSTRUCTIONS FOR CHARGER

- **This charger can be used by children aged from 8 years and above and persons with reduced physical, sensory or mental capabilities or lack of experience and knowledge if they have been given supervision or instruction concerning use of the charger in the safe way and understand the hazards involved. Children shall not play with the charger. Cleaning and user maintenance of the charger shall not be made by**

children without adult supervision.

- If the supply cord is damaged, it must be replaced by the manufacturer, its service agent or similarly qualified persons in order to avoid a hazard.
- Only use this charger CCH20V to charge the battery pack CBA20V2A.
- To charge the battery, use only the charger supplied
- Never charge non-rechargeable batteries.
- During charging the batteries must be placed in a well ventilated area

VIBRATION AND NOISE REDUCTION

To reduce the noise and vibration emission, limit the time of operation, use low-vibration and low noise operating modes as well as wear personal protective equipment.

Take the following points into account to minimize the vibration and noise exposure risks:

1. Only use the product as intended by its design and these instructions
2. Ensure that the product is in good condition and well maintained
3. Use correct attachments for the product and ensure they are in good condition
4. Keep tight grip on the handles surface
5. Plan your work schedule to spread any high vibration tool use across a longer period of time.

RESIDUAL RISK

Even if properly operating and handling this product in accordance with all the safety requirements, potential risks of injury and damage remain. Due to its construction and build, this tool may present the following hazards:

1. There is risk of a short-circuit due to liquids penetrating the housing. Do not immerse the product and the accessories in water. Make sure that no water or other liquids can enter the housing.
2. Ear damage if working without ear protection
3. The harmful /toxic dusts produced during operation pose the risk to the health of the operator and persons in the vicinity. Wear eye protection and a dust mask.
4. Keep a sufficient distance from heat sources.
5. The appliance is not a toy and does not belong in the hands of children.

Warning!

During operating, the product generates an electromagnetic field which, under certain circumstances, may impair the functionality of active or passive medical implants. To reduce the risk of serious or lethal injuries, we recommend that persons with medical implants consult their doctor and the manufacturer of their medical implant before operating the electric tool.

PRODUCT DESCRIPTION

(Fig.A)

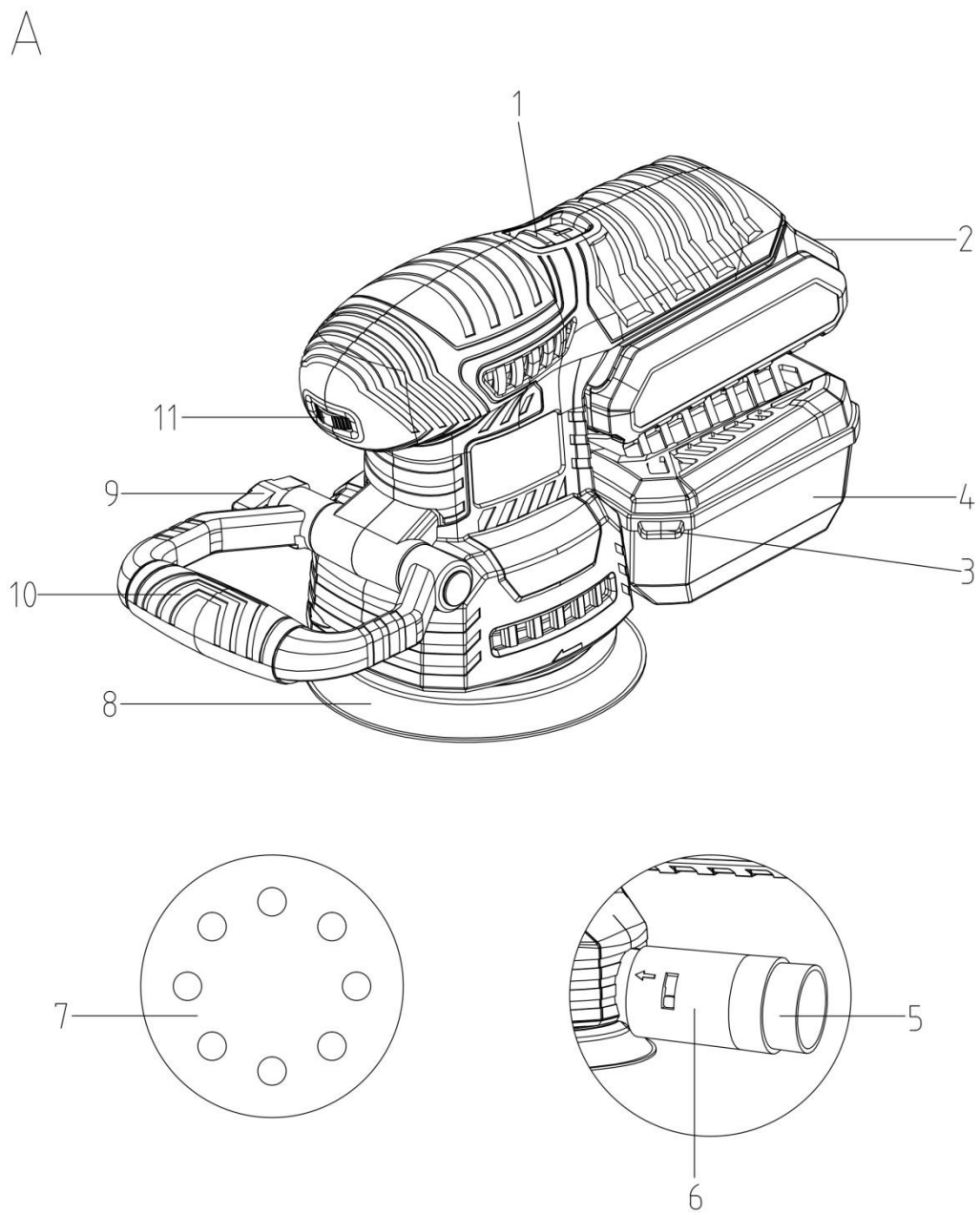

B

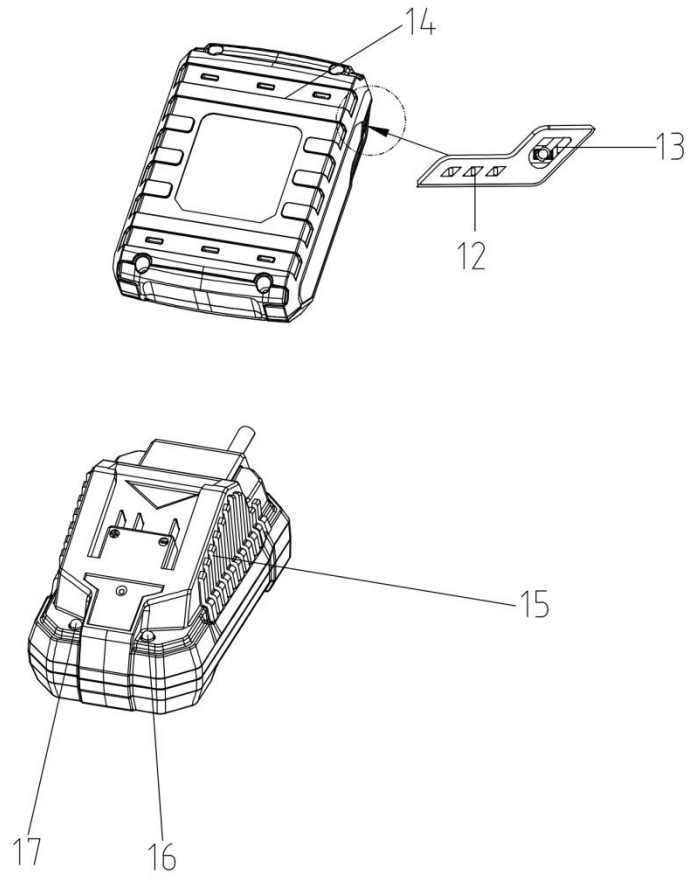

OVERVIEW (Fig.A)

1. ON/OFF switch
2. Battery release button
3. Tab on the dust box
4. Dust box
5. Reducer for external extraction appliances
6. Adapter fitting
7. Sanding sheet
8. Sanding plate
9. Screw
10. Additional handle
11. Speed setting wheel
12. Battery level indication (LED)
13. Battery charge level button
14. Battery pack
15. Charger
16. RED Charge control LED
17. GREEN charge control LED

INTRODUCTION

The operating instructions contain important information on safety, use and disposal. It is essential that you read the instructions before assembling, operation and maintaining the product. Use the product only as described and for the applications specified. Keep this manual safely and in the event that the product is passed on, hand over all documents to the third party.

TECHNICAL DATA

Rated voltage	20V d.c.
Rated no-load speed n_0	3000-12000/min
Sanding sheet	$\Phi 125\text{mm}$
Weight (without charger)	1.7kg
Battery pack	CBA20V2A
Type	Li-ion
Rated voltage	20V d.c.
Capacity	2.0Ah (40Wh)
Battery charger	CCH20V
Rated input	230-240V, 50Hz
Rated input Power	65W
Rated output	21.5V d.c.
Charging current	2.4A
Charging time	Approx. 60min
Protection class	II
Noise emission value	
Noise measurement value determined in accordance with EN 62841-2-4	
L_{PA}	86.27dB(A)
Uncertainty K	3dB(A)
L_{WA}	97.27dB(A)
Uncertainty K	3dB(A)
Vibration emission value	

Vibration value determined in accordance with EN 62841-2-1	
a _{h,D}	11.8 m/s ²
Uncertainty K	1.5 m/s ²

- The declared vibration total values and the declared noise emission values have been measured in accordance with a standard test method and may be used for comparing one tool with another.
- The declared vibration total values and the declared noise emission values may also be used in a preliminary assessment of exposure.

WARNING

- The vibration and noise emissions during actual use of the power tool can differ from the declared values depending on the ways in which the tool is used especially what kind of workpiece is processed; and
- It is necessary to identify safety measures to protect the operator that are based on an estimation of exposure in the actual conditions of use (taking account of all parts of the operating cycle such as the times when the tool is switched off and when it is running idle in addition to the trigger time)

INTENDED USE

This product is suitable for the dry sanding of wood, plastic, metal, filler and also painted surfaces. Any other uses or modification to the product are deemed to be improper usage and may result in serious physical injury. The manufacturer accepts no responsibility for damage(s) attributable to misuse. This product is designed for use by adults and not intended for commercial use.

BEFORE USE

UNPACKING

1. Unpack all parts and lay them on a flat stable surface
2. Make sure the delivery contents are complete and free of damage. If you find that parts are missing or show damage, do not use the product but contact your dealer/service centre. Do not use the product unless missing parts have been delivered in addition or defective parts have been replaced. Using an incomplete or damaged product represents a hazard to people and property.
3. Ensure that you have all the accessories and tools needed for assembly and operation.

SCOPE OF THE DELIVERY

Carefully unpack the cordless impact drill and check that it is complete:

- 1 x Battery-operated cordless orbital sander
- 1 x battery pack 2.0Ah
- 1 x battery charger
- 4 x random orbital sanding discs (grain size 60/80/120/240)
- 1 x dust box
- 1 x reducer for external dust extraction appliance
- 1 x transport case
- 1 x Instruction manual

CHARGING THE BATTERY PACK (FIG. B)

Note:

- **The battery can be damaged in case of improper charging.**
- **Remove the charger's mains plug before inserting or removing the battery.**

The battery is partially charged upon delivery to avoid damage to the battery caused by a deep discharge. Prior to initial start-up and when the battery is low, the battery should be charged. To do so, please proceed as follows (Fig. B):

1. Slide the battery pack (14) onto the charger (15) upside down till it locks in place.
2. Insert the mains plug of the charger (17) into a properly fused mains socket. The RED charge control LED (16) is illuminated; and charging requires approx. 60min.
3. Wait until the RED charge control LED (16) goes out and green charge control LED (17) is illuminated, the battery is fully charged.
4. Hold onto the mains plug while pulling the power cable of the charger out of the mains socket. The battery pack (14) and the charger (15) may have become warm during charging, allow the battery to cool down to room temperature.
5. Take the battery (14) out of the charger (15) by pressing and holding the battery release button (2) and pulling the battery pack (14) out of the charger (15).

REMOVING /INSERTING THE BATTERY

1. Slide the battery pack (14), place it on a guide track and push it back into the battery holder. It will audibly snap in.
2. Detach the battery pack (14) from the tool, press the battery release button (2) on the battery pack (14) and pull the battery off the tool.

CHECKING THE BATTERY CHARGING LEVEL

The battery comes with an integrated battery level indication.

The battery status is displayed as follows by the three LEDs of the battery level indication (LED) (12).

LED color	Meaning
Green-Orange-Red	Maximum charge/power
Orange-Red	Medium charge / power
Red	Weak charge – Recharge the battery

Press on the battery charge level button (13) on the battery pack (14). You can read the battery status from the battery level indication (LED) (12).

SELECTING A SANDING SHEET



WARNING! Wearing the protective gloves and a dust mask!

1. the material removal rate and surface quality are determined by the grain strength of the sanding sheet.
2. Please note that you need to use the appropriate sanding sheet with different grains for working different materials.

FITTING / REMOVING THE SANDING SHEET

 **WARNING! Remove the battery pack before carrying out any work!**

1. You can attach the sanding sheet (7) to the sanding plate using the Velcro.
2. Make sure that the extraction holes on the sanding sheet (7) match up with those on the sanding plate (8).
3. Removing sanding sheets fitted using Velcro.

DUST EXTRACTION

1. Dust box

- Connection: Slide the dust box (4) onto the appliance as far as the stop.
- Removal: pull the dust box (4) off the appliance.

Note: to achieve optimum dust extraction, the dust box (4) should be emptied regularly.

2. Reducer

- Connecting: push the reducer for external extraction appliance (5) into the adapter fitting (6). And push the hose from a suitable dust extraction appliance (e.g. a workshop vacuum cleaner) onto the reducer for external extraction appliances (5).
- Removal: pull the hose of the vacuum cleaner off the reducer for external extraction appliance (5) and remove it.

OPERATION

NOTE: always switch on the appliance before contact with the material and then apply the tool to the workpiece.

ADJUSTING THE ADDITIONAL HANDLE

You can adjust the additional handle (10) to several different positions.

1. Undo the screw (9) to reposition the additional handle (10).
2. Move the additional handle (10) to the desired position.
3. Retighten the screw (9).

SWITCHING ON AND OFF

 **Warning! Wear your personal protective equipment when working with the device.**

1. Move the ON/OFF switch (1) to the “I” position to switch on the appliance.
2. Move the ON/OFF switch (1) to the “O” position to switch off the appliance.

SETTING THE ROTATIONAL SPEED

Adjust the speed setting wheel (11) to a position between 1 and 6 to get the desired rotational speed.

WORKING PROCEDURE

1. Switch the appliance on before applying it to the workpiece.
2. Apply minimal pressure when working.
3. Work at a constant speed.
4. Change the sanding sheets regularly.
5. Never use the same sanding sheet for sanding different materials (e.g. wood followed by metal). Optimum sanding results can only be achieved by using clean sanding sheet.

6. Clean the sanding sheet every once in a while using a vacuum cleaner.
7. Sand hard-to-reach places with the front or side edge of the sanding sheet on the sander plate.
8. Guide the sander over the workpiece in parallel and use overlapping sanding motions.
9. After completing the task, lift the appliance from the workpiece and then switch it off.

CLEANING & MAINTENANCE



Warning! Risk of injury. Always switch the appliance off and remove the battery before carrying out any work on the appliance.

1. Always clean the appliance immediately after completing work.
2. Use a dry cloth to clean the housing.
3. Remove any sanding dust stuck to the appliance with a brush.
4. Never use sharp objects, petrol, solvents or cleaning agents which can damage plastic. Do not allow any liquids to get into the interior of the appliance.

STORAGE AND TRANSPORTATION

Before storing /transporting the appliance, observe the following:

1. Switch off the device
2. Hold onto the mains plug while pulling the power cable of the charger out the mains socket.
3. Allow the appliance to cool down.
4. Remove the battery from the device.
5. Remove the sanding sheet.
6. Clean the devices as described in the cleaning & maintenance section.
7. For storing / transporting the appliance, use the transport case included in the scope of the delivery in order to protect the device from external influences.
8. Do not store Li-ion battery with are completely discharged. Storing discharged battery can lead to a deep discharge and thus damage the battery.
9. Protect the product from any heavy impact or strong vibrations which may occur during transportation in vehicles

REPLACEMENT PARTS /ACCESSORIES

AVAILABLE ACCESSORIES



Warning! Only use accessories and additional equipment specified in the operating manual. Using insertion tools or accessories other than those specific in the operating manual may cause a risk of injury. Only get the accessories from the Service Centre.

Spare charger & battery pack for 20V platform		
Charging time	Battery Pack CBA20V2A 2Ah	Battery Pack CBA20V4 4Ah
Charger CCH20V	60min	120min

All 20V team shares the compatible charger and battery pack of 20V platform.

TROUBLESHOOTING



Warning! Only perform the steps described within these instructions. All further inspection, maintenance and repair work must be performed by an authorized service center or a similarly qualified specialist if you cannot solve the problem yourself. Suspected malfunctions are often due to causes that the users can fix themselves. Therefore, check the product using this section. In most cases the problem can be solved quickly

Problem	Possible cause	Corrective action
The tool won't start	Battery discharged	Recharge battery
	Battery not inserted	Insert battery
	On/Off switch defective	Send in to Service Centre for repair
	Battery terminals on dirt	Remove the dirt.
The sanding performance is insufficient	The sanding sheet is not suitable	Change to a suitable sanding sheet
	The sanding sheet is worn out	Changing a new sanding sheet.
The sander becomes hot	too much pressure on the device when sanding	Reduce the pressure during sanding

Note: if your device does not operate correctly after these check, please contact the Service Center.

DISPOSAL



To help the environment, please dispose of the product properly when it has reached the end of its useful life and not in the household waste. Information on collection points and their opening hours can be obtained from your local authority



Environmental damage through incorrect disposal of the batteries / rechargeable batteries.

Remove the battery pack from the product before disposal. Batteries /rechargeable batteries may not be disposed of with the usual domestic waste. They may contain toxic heavy metals and are subject to hazardous waste treatment rules and regulations. Please dispose of batteries according to the relevant local requirements

N° : 4099-2021-SM-CE- -DY94429



**DÉCLARATION CE / UE DE CONFORMITÉ
EC / EU DECLARATION OF CONFORMITY
EG / EU VERKLARING VAN OVEREENSTEMMING
DECLARACIÓN CE / UE DE CONFORMIDAD**

Nom et adresse du fabricant (1) / nom et adresse de la personne autorisée à constituer le dossier technique (2)
Name and address of the manufacturer (1) / name and address of the person authorised to compile the technical file (2)
Firmaanaam en adres van de fabrikant (1) / Naam en adres van degene die gemachtigd is het technisch dossier samen te stellen (2)
Nombre y dirección del fabricante (1) / Nombre y dirección de la persona facultada para reunir el expediente técnico (2)

Carrefour Marchandises Internationales / CMI – Christophe Legraverend
93 avenue de Paris
91300 Massy – France

Identification du produit:
Identification of the product:
Identificatie van de machine
Identificación del producto:

DY94429

Description et identification de la machine (3) :
Description and identification of the machinery (3):
Beschrijving en identificatie van de machine (3) :
Descripción e identificación de la máquina (3):

Carrefour, PONCEUSE SANS FIL, DY94429/ CCOS20V2A
Numéro de série / Serial number / Het serienummer/ Número de serie : 20210714372-20210715183

L'objet de la déclaration décrit ci-dessus satisfait à l'ensemble des dispositions pertinentes du code du travail Français et de l'arrêté royal Belge du 12 AOUT 2008 (4). Het hierboven beschreven voorwerp voldoet aan alle toepasselijke bepalingen van Koninklijk besluit van 12 Augustus 2008 (4)

The object of the declaration described above fulfils all the relevant provisions of Directive 2006/42/CE (4)
El objeto de la declaración descrita anteriormente cumple todas las disposiciones aplicables de la Directiva 2006/42/CE (4)

Références des normes harmonisées pertinentes appliquées ou des spécifications par rapport auxquelles la conformité est déclarée(7,8) :
References to the relevant harmonised standards used or references to the specifications in relation to which conformity is declared (7,8):
Vermelding van de toegepaste relevante geharmoniseerde normen of van de specificaties waarop de conformiteitsverklaring betrekking heft (7,8):
Referencias a las normas armonizadas pertinentes utilizadas, o referencias a las especificaciones respecto a las cuales se declara la conformidad (7,8):

EN 62841-1:2015

L'objet de la déclaration décrit ci-dessus est conforme à la législation d'harmonisation de l'union applicable:
The object of the declaration described above is in conformity with the relevant Union harmonization legislation:
Het hierboven beschreven voorwerp is conform de desbetreffende harmonisatiewetgeving van de Unie:
El objeto de la declaración descrita anteriormente es conforme a la legislación de armonización pertinente de la Unión:

Références des normes harmonisées pertinentes appliquées ou des spécifications par rapport auxquelles la conformité est déclarée:
References to the relevant harmonised standards used or references to the specifications in relation to which conformity is declared:
Vermelding van de toegepaste relevante geharmoniseerde normen of van de specificaties waarop de conformiteitsverklaring betrekking heeft:
Referencias a las normas armonizadas pertinentes utilizadas, o referencias a las especificaciones respecto a las cuales se declara la conformidad:

DIRECTIVE 2014/30/EU (EMC)	EN 55014-1:2017+A11:2020 EN 55014-2:2015 EN IEC 61000-3-2:2019 EN 61000-3-3:2013+A1:2019
DIRECTIVE 2014/35/EU (LVD)	EN 60335-1:2012+A11:2014+A13:2017+A1:2019+A14:2019+A2:2019 EN 60335-2-29: 2004+A2:2010+A11:2018 EN 62233:2008
DIRECTIVE 2011/65/EU (ROHS)	-

Signé par et au nom de: **Christophe LEGRAVEREND**
Signed for and on behalf of: Non-Food Quality Director
Ondertekend voor en namens: Carrefour Marchandises Internationales/CMI
Firmado por y en nombre de:

Date et lieu d'établissement: Massy, 18/08/2021
Place and date of issue:
Datum van afgifte en plaats:
Lugar y fecha de expedición:

WARRANTY

The manufacturer guarantees the product against defects in material and workmanship for a period of 2 years from the date of the original purchase. The warranty only applies if the product is for household use. The warranty does not cover breakdowns due to normal wear and tear.

The manufacturer agrees to replace parts identified as defective by the designated distributor. The manufacturer does not accept responsibility for the replacement of the machine, in whole or in part, and/or ensuing damage.

The warranty does not cover breakdowns due to:

- insufficient maintenance.
- abnormal assembly, adjustment or operations of the product.
- parts subject to normal wear and tear.

The warranty does not extend to:

- shipping and packaging costs.
- using the tool for a purpose other than that for which it was designed.
- the use and maintenance of the machine done in a manner not described in the user manual.

Due to our policy of continuous product improvement, we reserve the right to alter or change specifications without notice. Consequently, the product may be different from the information contained therein, but a modification will be undertaken without notice if it is recognized as an improvement of the preceding characteristic.

READ THE MANUAL CAREFULLY BEFORE USING THE MACHINE.

When ordering spare parts, please indicate the part number or code, you can find this in the spare parts list in this manual. Keep the purchase receipt; without it, the warranty is invalid. To help you with your product, we invite you to contact us by phone or via our website:

+33 (0)9.70.75.30.30
<https://services.swap-europe.com/contact>

You must create a "ticket" via the web platform.

- Register or create your account.
- Indicate the reference of the tool.
- Choose the subject of your request.
- Describe your problem.

Attach these files: invoice or sales receipt, photo of the identification plate (serial number), photo of the part you need (for example: pins on the transformer plug which are broken).



PRODUCT FAILURE

WHAT TO DO IF MY MACHINE BREAKS DOWN?

If you bought your product in a store:

- Make sure that your machine is complete with all accessories supplied, and clean! If this is not the case, the repairer will refuse the machine.
- Go to the store with the complete machine and with the receipt or invoice.

If you bought your product on a website:

- Make sure that your machine is complete with all accessories supplied, and clean! If this is not the case, the repairer will refuse the machine.
- Create a SWAP-Europe service ticket on the site: <https://services.swap-europe.com> When making the request on SWAP-Europe, you must attach the invoice and the photo of the nameplate (serial number).

Contact the repair station to make sure it is available before dropping off the machine.

Go to the repair station with the complete machine packed, accompanied by the purchase invoice and the station support sheet downloadable after the service request is completed on the SWAP-Europe site

Please keep your original packaging to allow for after-sales service returns or pack your machine with a similar cardboard box of the same dimensions.

For any question concerning our after-sales service you can make a request on our website <https://services.swap-europe.com>

Our hotline remains available at +33 (9) 70 75 30 30.



WARRANTY EXCLUSIONS

THE WARRANTY DOES NOT COVER:

- Start-up and setting up of the product.
- Damage resulting from normal wear and tear of the product.
- Damage resulting from improper use of the product.
- Damage resulting from assembly or start-up not in accordance with the user manual.
- Breakdowns related to carburetion beyond 90 days and fouling of carburetors.
- Periodic and standard maintenance events.
- Actions of modification and dismantling that directly void the warranty.
- Products whose original authentication marking (brand, serial number) has been degraded, altered or withdrawn.
- Replacement of consumables.
- The use of non-original parts.
- Breakage of parts following impacts or projections.
- Accessories breakdowns.
- Defects and their consequences linked to any external cause.
- Loss of components and loss due to insufficient screwing.
- Cutting components and any damage related to the loosening of parts.
- Overload or overheating.
- Poor power supply quality: faulty voltage, voltage error, etc.
- Damages resulting from the deprivation of enjoyment of the product during the time necessary for repairs and more generally the costs related to the immobilization of the product.
- The costs of a second opinion established by a third party following an estimate by a SWAP-Europe repair station
- The use of a product which would show a defect or a breakage which was not the subject of an immediate report and/or repair with the services of SWAP-Europe.
- Deterioration linked to transport and storage*.
- Launchers beyond 90 days.
- Oil, petrol, grease.
- Damages related to the use of non-compliant fuels or lubricants.

* In accordance with transport legislation, damage related to transport must be declared to carriers within 48 hours maximum after observation by registered letter with acknowledgement of receipt.

This document is a supplement to your notice, a non-exhaustive list.

Attention: all orders must be checked in the presence of the delivery person. In case of refusal by the delivery person, it you must simply refuse the delivery and notify your refusal.

Reminder: the reserves do not exclude the notification by registered letter with acknowledgement within 72 hours.

Information:

Thermal devices must be wintered each season (service available on the SWAP-Europe site). Batteries must be charged before being stored.

Staple here your receipt

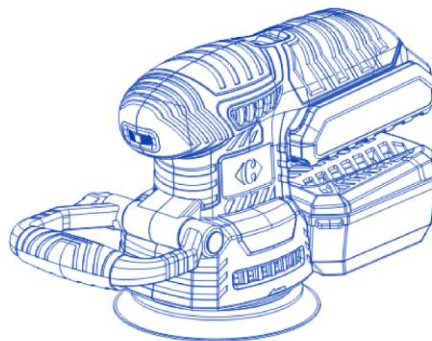

Product	Ref	EAN
Cordless Orbital Sander	DY94429	3616474483514



EN

For any comments or suggestions

Carrefour Consumer service
– CMI
TSA 91431

91343 MASSY Cedex
France
www.carrefour.fr

 **N° Cristal** 09 69 39 70 00

APPEL NON SURTAXE

More information on
www.mycarrefourdocs.com